



STEP 1 – PRIOR TO INSTALLATION

- A) Bushwacker only** approves installing the flares according to these written instructions with the hardware provided. **WARNING:** Failure to install according to these instructions will invalidate the warranty. This includes, but is not limited to using alternative installation methods, hardware, or materials. **DO NOT USE:** Loctite, SuperGlue, or similar products on the hardware or the flares.
- B) Fit:** Verify the fit of the flares to vehicle. (Some filing, sanding, or cutting may be necessary to ensure proper fit).
- C) Painting:** (Optional) if paint is desired it must be done prior to installing flares on vehicle. Clean outer surface with a good grade degreaser. **DO NOT USE LACQUER THINNER OR ENAMEL REDUCER AS A DEGREASER.** Wipe outer surface thoroughly with a tack rag prior to paint. Application of plastic adhesion promoter for ABS plastic as per your paint system manufacturer's recommendations is required. Paint flares using a high quality enamel, or polyurethane automotive paint. If painting edge trim (not recommended), use a flex additive.
- D) Performance:** Using larger Tires may increase the area required to turn the vehicle. Some Tire/Rim combinations may require lowering bump stops and or installing steering stops to prevent tire from contacting flare.
- E) Exhaust System:** Modifications may be necessary to maintain a minimum 4" clearance between flares and exhaust pipes. (Exhaust gases should not vent directly onto flares)
- F) Metal Protection:** All exposed fasteners and bare metal should be treated with rust resistant paint **BEFORE** installing flares. Spray inner fender wells with undercoating **AFTER** flare attachments have been completed.
- G) Decals:** Flares may interfere with existing decals on vehicle. If you wish, remove decals prior to installation of flares.
- H) Care & Cleaning:** Bushwacker fender flares are built to last; any detergent you use to wash your vehicle is sufficient to clean the flare. Do not use any harsh abrasive detergents.

Suzuki Pocket Style® Fender Flares Rear Pair

Front Part #60016-07

Rev-4 2/16/2016

For complete fitment info visit : www.bushwacker.com

TOOLS FOR EASY INSTALLATION:

- Utility Knife
- Electric Drill
- 3/16" Drill Bit
- 5/16" Socket
- 6" Extension
- Grease Pencil
- Masking Tape

PLEASE READ: Dirt and debris can become lodged between the fender flares and the vehicle's fenders, causing scratching and paint wear from vibration. Lund International is not responsible for any damage, and the installation of our fender flares is done with the buyer's understanding that this scratching and paint wear may occur.

LIMITED LIFETIME WARRANTY AGAINST ANY MANUFACTURING DEFECTS

- To claim a warranty, you must provide Proof of Purchase.

Included in Hardware Kit:



SW1-0045,
#14-14 x 1"
Torx Screw,

14 pcs



SP1-0009,
3/8" x 5/8" x .187"
Neo Black Spacer,

14 pcs



SW1-0052,
T-45 Torx Bit,

1 pc



ET1-0002,
Edge Trim Tool,

1 pc



GP1-0005,
Large Wiper Style
Edge Trim,

108 inches

STEP 2 - EDGE TRIM INSTALLATION

A. Applying the adhesive side of the edge trim (GP1-0005) to the inner side of the flare, affix the edge trim to the top edge of the flare (the portion that comes in contact with the vehicle).

B. Press edge trim into place along the top edge of the flare in one-inch increments.

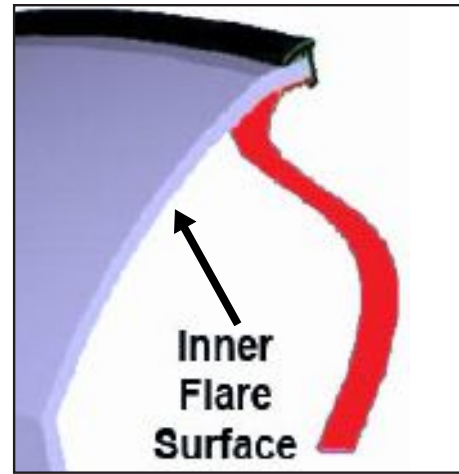

Rear Flare Installation Procedures (Driver's Side):



Starting at rear of factory flare, pull up then out on flare to pop it off the metal lip. This will pull plastic rivets from the holes in factory flare. If rivets do not come out, remove them.



Optional Step in Cases Where Factory Rocker Moldings are Still on Vehicle: Hold flare in position on vehicle and mark where it interferes with rocker molding. Cut a notch into the flare on mark with utility knife.



For rear of rear flare, use style line of vehicle as guide for where flare should line up. If there is a rear bumper endcap extending above this line then it will need to be trimmed.



Hold rear flare in position on fender and, using a grease pencil, mark each hole location on sheet metal.



At each of the marked locations drill through sheet metal using a 3/16" bit. If necessary, drill through both layers of sheet metal because they overlap.



At each flare pocket, insert a Screw (SW1-0045) and run it into a Spacer (SP1-0009) until snug with the flare plastic. Use a 5/16" socket and 6" extension to prevent marring flare plastic. Wrap a layer of masking tape around Torx Bit (SW1-0052) to help it stay in the socket.



Hold the flare to the fender, lining screws up with 3/16" drilled holes and start screws into sheet metal. Once all screws are started, tighten to 2 ft•lb of torque.

Edge Trim Tool Procedures:

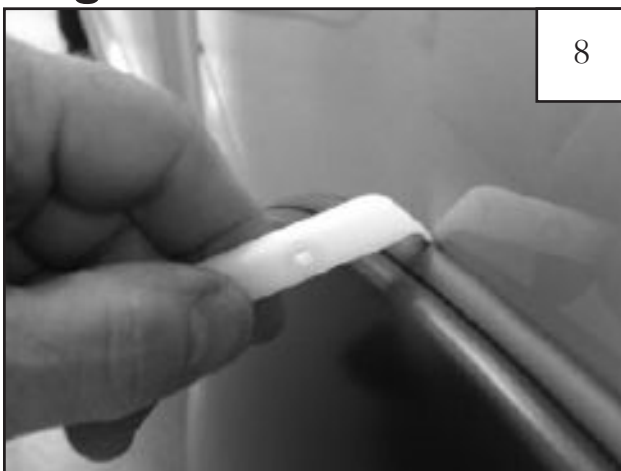

Using supplied Edge Trim Tool (ET1-0002), seat edge trim against vehicle by hooking curved end under edge trim at one end of flare. Next, slide around outer edge of flare to the other end.



Using flat end of supplied Edge Trim Tool (ET1-0002), seat edge trim against flare by inserting straight end between edge trim and flare at one end. Next, slide around entire edge to the other end.